

# Rebuild Instructions

## LP Series Rising Plug Valve

**⚠ WARNING**

Before disassembly be sure to provide a clean area to keep components for reuse.

**Tools Required**

Tool	Description	Size	LP6	Part
Vise			3/4 in.	Bonnet
				Packing Nut
				Panel Nut
Torque wrench			3/8 in.	Packing Bolt
			5/32 in.	Socket Screw
Christo-Lube MCG 130 +MCGIII lube			1/8 in.	Set Screw

### Disassembly

1. Rotate the handle so that the valve is in the fully open position.



2. Use an allen wrench to loosen the set screw in the handle.

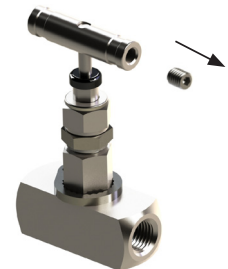

3. Lift the handle over the upper stem.

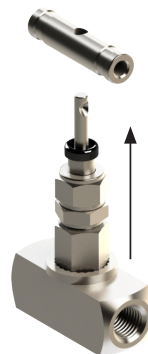

4. Loosen the socket set screw with an allen wrench and remove from the bonnet lock. The bonnet lock will now be free to lift up over the bonnet.

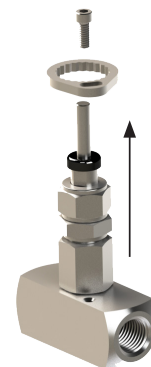

5. Use a wrench to remove the bonnet assembly from the body (Discard this bonnet assembly if replacing with a new one.)

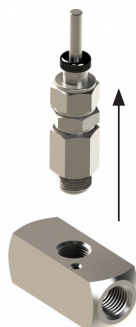

6. For plug seat replacement use the following steps: Insert a pick tool/allen wrench into one of the seat's through holes and pry the seat up and out of the body.

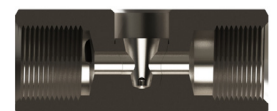

7. Discard the plug seat and the seat pin (if attached). The seat pin may still be secured in the body.



8. To replace the plug seat use the following steps: Add Christo-Lube MCG 111 lubrication over the entire plug seat part. Insert the seat pin into the bottom slot of the plug seat

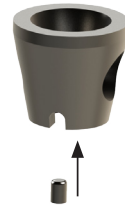

9. The seat pin should sit vertical in the slot as shown.



10. Position the plug seat over the body so that the pin aligns with the pin hole in the orifice of the body. Push the plug seat into the body and the pin should fit into the pin hole. This prevents the plug seat from rotation



11. Lubricate the bonnet threads with the provided Christo-Lube MCG 130. Use a torque wrench to tighten the bonnet into the body using the torque chart below. (Make sure that the stem is in the open position before tightening into the body)

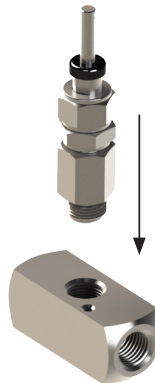

12. Place the bonnet lock back over the body and align slot with the threaded socket screw hole.

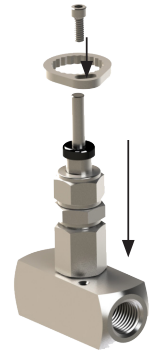

13. Slide the handle over the upper stem so that the threaded hole in the handle aligns with the set screw point on the upper stem. Insert the set screw into the handle's threaded hole and tighten with an allen wrench until "snug".



14. Test the opening and closing of the valve. the assembly is now complete.



Part	Torque Required	
	in.·lb	ft·lb
Acetal Seat	80	7
PFA Seat	30	3
PEEK Seat	80	7